

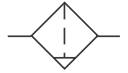

»GA-mini« Series

GAF 05, GAF 06

Symbol



Product features

Centrifugal separators with a sintered filter element.

Specifications / Technical data

Type	Size 200	
	GAF 05	GAF 06
Fluid	Air	
Port size	1/8"	1/4"
Filtering grade	5 µm (40 µm on request)	
Pressure range	1.5 to 9 bar (0.15 to 0.9 MPa, 20 to 130 psi)	
Inlet pressure max.	10 bar (1.0 MPa, 145 psi)	
Temperature range	-5 to 70 °C	
Capacity of drain bowl	18 cm ³	
Weight	150 g	

Ordering information

Type	description
GAF 05, GAF 06	Filter with polycarbonate bowl and »HW« mounting bracket, semi-automatic drain valve

Flow chart

GAF 05, GAF 06

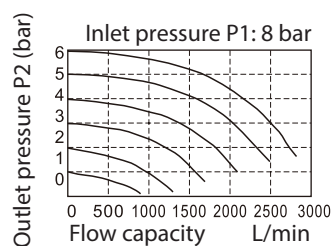

»GA-mini« Series

GAF 05, GAF 06

Body dimensions

GAF 05, GAF 06

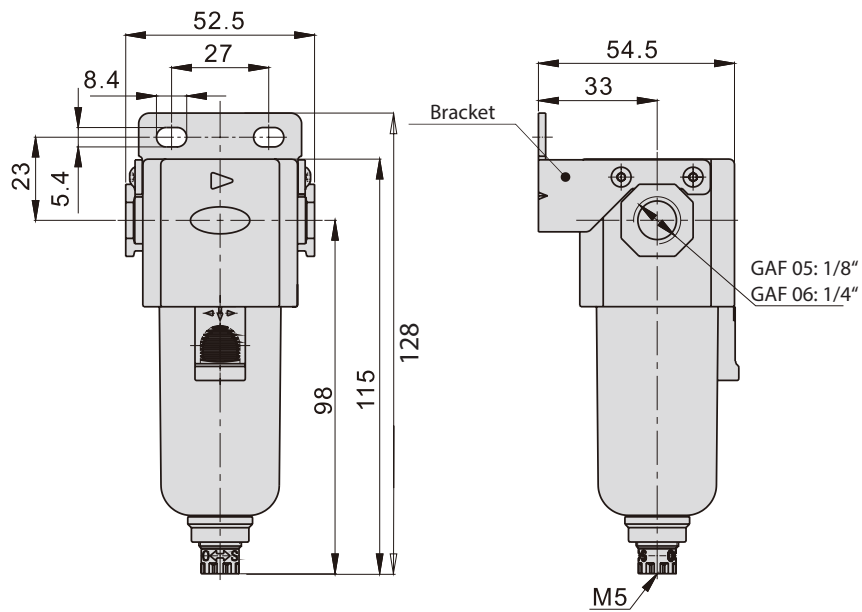

»GA-mini« Series

GAF 05, GAF 06

Components and materials



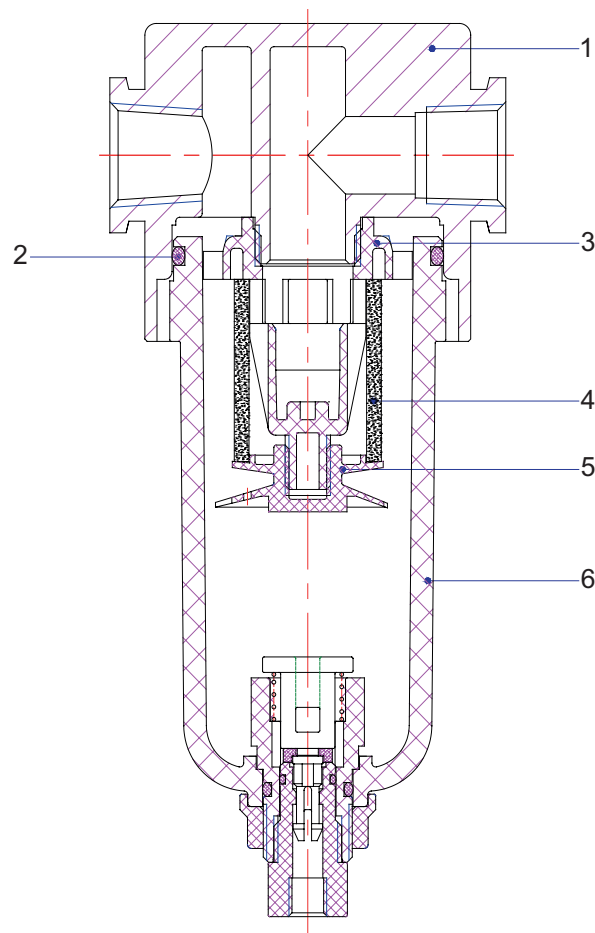

No.	Item	Material
1	Body	Aluminum alloy
2	O-ring	NBR
3	Air guider	POM high viscosity
4	Filter core	HDPE
5	Umbrella baffle	POM high viscosity
6	Drain bowl	PC



»GA-mini« Series

GAF 05, GAF 06

Accessories

	Art. No.	Type	description
	179145	GAF 05 400	Filter element 5 µm
	179147	HW 201-A	Mounting bracket, incl. 4 screws
	116612	UB 200	Joiner without wall mounting
	116515	LB 200	Joiner with wall mounting, 1 drilled hole
	116608	TB 200	Joiner with wall mounting, 2 drilled holes